

TRADE ESSENTIALS

FIRST FOR TOOLS,
CONSUMABLES AND
WORKSHOP EQUIPMENT

ISSUE 39

1 NOVEMBER - 31 DECEMBER 2019



17" FLEX HANDLE
INCLUDED

SOCKET SET

NEW

1/2"

44
Pieces



CLICK
LOCK

FULL
RANGE OF
1/2" DRIVE
METRIC +
AF SOCKETS



Part # T1244

SCREWDRIVERS



16 + 21MM SPARK
PLUG SOCKETS

- 1/2" drive 12 point regular sockets: 10mm - 32mm
- 1/2" drive 12 point regular sockets: 3/8" - 1"
- 1/2" drive 12 point deep sockets: 10, 13, 17, 19mm
- FRP ratchet & 17" flex handle
- 2 1/2", 5" & 10" extension bars
- Universal joint & 3/8" F : 1/2" M adaptor
- 16 & 21mm spark plug sockets
- Screwdrivers: PZ1, PZ2, Flat 5.5, 6.5mm
- Double ring spanner: 10 x 13mm

\$199.00

\$228.85 inc GST

NEW SOCKET SIZES

INCLUDED IN THIS SET AND
AVAILABLE INDIVIDUALLY

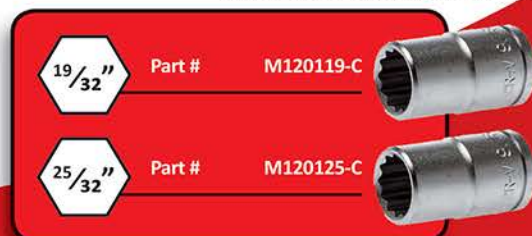

A set of four pre-set open end torque spanners especially developed for use on Brass Flare Connections in Air Conditioning & Refrigeration.

Manufactured to Standard ISO6789-1992. Accuracy +/- 4%

Set Includes:

- 17mm Preset Torque Spanner 18Nm
- 22mm Preset Torque Spanner 42Nm
- 26mm Preset Torque Spanner 55Nm
- 29mm Preset Torque Spanner 65Nm

\$461.00

\$530.15 inc GST

4 Pc Preset Torque Spanner Set



Part # ACD01



**OFFICIAL
SUPPLIER**
Defender America's Cup 36



IF YOU HAVEN'T GOT IT, YOU CAN'T USE IT!

Industrial & Commercial Fans

PROEquip
Professional Equipment

KEEP YOUR COOL BEAT THE HEATWAVE

750mm Pedestal Fan w/ Heavy Duty Cast Iron Base PE1015



\$298.00

\$342.70 inc GST

- 240V / 50Hz 280W
- 3 Speed Motor - 1400rpm (max)
- 750mm Alloy 3-Blade Fan
- Air Flow Delivery upto 290m³/min
- db(A) - 86
- 0° to 90° Oscillating Angle
- Metal Oscillating Gears



\$282.00

\$324.30 inc GST

750mm Wall Fan w/ Heavy Duty Wall Bracket PE1026

450mm Floor Fan PE1045



- 240V / 50Hz 135W
- 3 Speed Motor - 1400rpm (max)
- 450mm Steel 3-Blade Fan
- Air Flow Delivery upto 124m³/min
- db(A) - 69
- Adjustable Flow Angle

\$175.00

\$201.25 inc GST

450mm Wall Fan PE1161



- 240V / 50Hz 100W
- 3 Speed Motor - 1400rpm (max)
- 450mm Alloy 3-Blade Fan
- Air Flow Delivery upto 124m³/min
- db(A) - 57
- Heavy Duty Wall Fixing Plate
- 0° to 90° Oscillating Angle
- Metal Oscillating Gears

\$199.00

\$228.85 inc GST

**Note: These fans are designed for industrial/
commercial use, not recommended for home
use.**

Certified to AS/NZS 60335

PROequip Industrial Fans carry a 12 month commercial use limited warranty against faulty workmanship and materials. A full range of replacement and spare parts are available.



Climate Class
T45
except PE1045

Industrial Ventilation Fans

PROEquip
Professional Equipment

PE1025

List Price - \$482.00 EXC GST

\$554.30 INC GST



300mm Industrial Ventilation Fan

- 240V / 50Hz 320W
- 5M of Flexible Ducting
- 300mm Alloy Multi Blade Fan (2850rpm)
- Air Delivery - 65m³/min
- Static Pressure - 373Pa
- dB(A) - 71

PE1140

List Price - \$408.00 EXC GST

\$469.20 INC GST



200mm Industrial Ventilation Fan

- 240V / 50Hz 145W
- 5M of Flexible Ducting
- 200mm Alloy Multi Blade Fan (2850rpm)
- Air delivery - 25m³/min
- Static Pressure - 245Pa
- dB(A) - 63

PE1056

List Price - \$877.00 EXC GST

\$1008.55 INC GST



400mm Industrial Ventilation Fan

- 240V / 50Hz 1000W
- 5M of Flexible Ducting
- 400mm Alloy Multi Blade Fan (2800rpm)
- Air Delivery - 128m³/min
- Static Pressure - 700Pa
- dB(A) - 80

PE1141

List Price - \$965.00 EXC GST

\$1109.75 INC GST



450mm Industrial Ventilation Fan

- 240V / 50Hz 1450W
- 5M of Flexible Ducting
- 450mm Alloy Multi Blade Fan (2800rpm)
- Air Delivery - 162m³/min
- Static Pressure - 972Pa
- dB(A) - 83

Certified to AS/NZS 60335

**PROVEN QUALITY
RELIABLE PERFORMANCE
FULLY APPROVED**

Designed for industrial use, solid construction with long life direct drive commercial motor. These industrial fans are excellent for work sites, workshops, warehouses, garages or sheds.

Drill Bit Sharpeners

DRILL DOCTOR INDUSTRIAL DD750X

Features

- Variable 2.5mm to 19mm drill bit capacity
- Variable 115° to 140° sharpening angle
- Creates & restores split point bits
- Adjustable relief angle
- Adjustable material removal
- 240V motor
- Moulded carry case

\$547.00

~~\$629.05~~ inc GST

Variable Alignment

Lets you adjust chisel & relief angle

E-Z Alignment System

Fast, easy and assures precise sharpening alignment, even of small bits

Patented Dual-Cam Sharpening System

Professionally sharpen your bits with a few easy turns

Patented Chuck Design

Front loading chuck holds 2.5 to 19mm (3/32" to 3/4") drill bits for precision geometry; makes small bits easy to align.

Part No.	DD750X
Drill Bit Capacity	2.5 - 19mm (3/32" to 3/4")
Point Angle	115° to 140°
Voltage	240V 1PH

Variable Point Angle

115° to 140°

User Replaceable Diamond Sharpening Wheel

The diamond wheel is easy to replace after several hundred sharpenings



DRILL DOCTOR INDUSTRIAL DD500X

The Drill Doctor 500X model is designed for the tradesman requiring a versatile sharpener for every day use. The 500X has the durability and the flexibility required to sharpen the largest range and most popular sizes of dull or broken bits, including split points and masonry bits.

- Sharpens standard twist and masonry bits from 2.5 to 13mm (3/32" to 1/2") (optional 3/4" chuck available)
- Sharpens 118° and 135° point angles
- Cast aluminium point angle shuttle for added durability
- Longer chuck jaws hold bits more precisely, and jaw guides eliminate jaw twisting on small bits
- Able to create and sharpen split point bits.
- "Push to Stop" drill point splitting port: prevents over-splitting the bit point
- Easy to replace diamond sharpening wheel



\$437.00

~~\$502.55~~ inc GST

DRILL DOCTOR MODEL XP DDXP

The Drill Doctor XP is perfect for the serious DIY'er and trade professional user who needs to sharpen bits frequently.

The XP is a must have for your workshop or tool kit, allowing you to save time and money.

- Sharpens standard twist and masonry bits from 2.5 to 13mm (3/32" to 1/2")
- Sharpens and creates split point bits
- Diamond sharpening wheel
- Powerful 240V motor
- 118° Point angle
- Adjustable relief angle



\$251.00

~~\$288.65~~ inc GST

Knife & Tool Sharpeners

KNIFE & TOOL SHARPENER - 'KEN ONION' EDITION WSKTS-KO

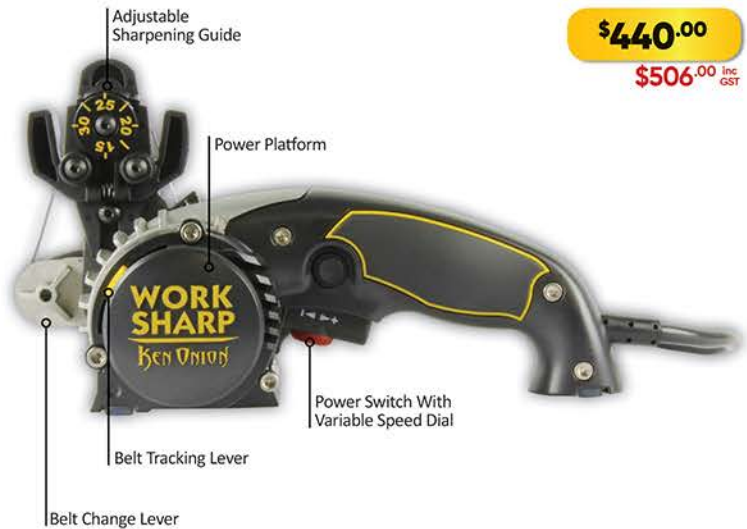

\$440.00

\$506.00 inc GST

Work Sharp has teamed up with renowned knife maker Ken Onion to deliver the ultimate sharpening solution for your home or workshop. The Work Sharp Knife & Tool Sharpener - "Ken Onion Edition" will sharpen every knife you own, quickly and easily.

- 3/4" x 12" premium, flexible Abrasive Belts
- Adjustable Knife Sharpening Guide in 1° increments from 15° to 30°
- Variable Speed Control 6000 to 14000rpm provides optimal belt speed

Includes 5 Piece Abrasive Belt Kit:

- P120 Extra Coarse
- X65 Coarse
- X22 Medium
- X4 Fine
- 6000 Extra Fine

Optional Attachments (not included)

- WSSAKO81112 - Blade Grinder
- WSSAKO81111 - Tool Grinder



\$106.00

\$121.90 inc GST

WSSAKO81111



\$203.00

\$233.45 inc GST

WSSAKO81112

WORKSHARP KNIFE & TOOL SHARPENER - 92W WSKTS



\$220.00

\$253.00 inc GST

The Work Sharp Knife & Tool Sharpener gives you a perfect convex edge on any knife blade. The secret is the flexible belt technology. The belt flexes to any blade shape and creates a strong, shaving edge on your blade.

- Serrated knife guide
- Scissor sharpening guide
- 50° guide for hunting and outdoor knives (25° per bevel)
- 40° guide for thinner blades and kitchen knives (20° per bevel)

Includes 5 Piece Abrasive Belt Kit:

- P80 Coarse (1)
- P220 Medium (2)
- 6000 Fine Honing (2)

WORKSHOP GUIDED FIELD KNIFE SHARPENER WSGFS221

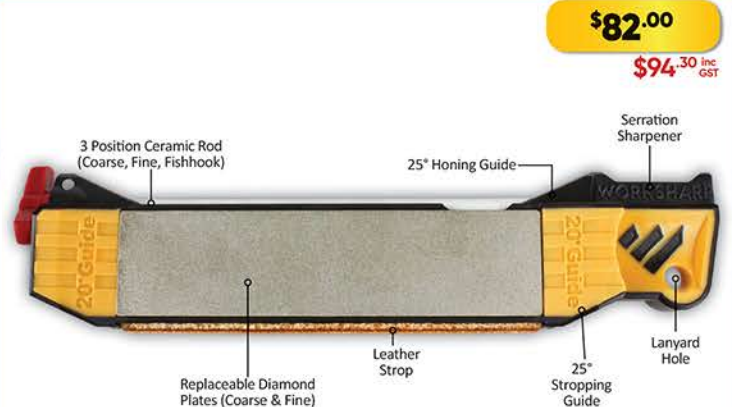

\$82.00

\$94.30 inc GST

The Work Sharp Guided Field Sharpener is the first Angle Guided, 5 stage sharpening solution designed for sportsmen who need a complete, robust and compact field sharpening solution. The 20° & 25° sharpening guides create consistent blade edge angles.

Holemaker Mag Base Drills

QUALITY EUROPEAN MADE MAGNETIC DRILLING MACHINES

PRO35 MAGNETIC BASE DRILL HMPRO35



Capacity (Diameter)	35mm
Capacity (Depth)	52mm
Motor Power	920 watt
Input Power	1000 Watt Single Phase 240V
Speed	350rpm
Weight	10.0kg
Magnetic Dead Lift	9500Nm On 25mm Steel Plate
Stroke	70mm
Height (min / max)	306 / 376mm
Through Spindle Coolant System	
Smart Magnet Technology To Ensure Sufficient Magnetic Adhesion	
Supplied In Plastic Carry Case With Cutter Guard & Safety Strap	

\$999.00

\$1148⁸⁵ inc GST

Optional Accessories & Consumables



Holemaker Cutters



Weldon Shank Drills

PRO40 MAGNETIC BASE DRILL HMPRO40



Capacity (Diameter)	40mm
Capacity (Depth)	52mm
Capacity (Twist Drill)	13mm
Motor Power	1020 watt
Input Power	1100 Watt Single Phase 240V
Speed	440rpm
Weight	12.5kg
Magnetic Dead Lift	10650Nm On 25mm Steel Plate
Stroke	124mm
Height (min / max)	385 / 509mm
Through Spindle Coolant System	
Smart Magnet Technology To Ensure Sufficient Magnetic Adhesion	
Supplied In Metal Carry Case With Cutter Guard & Safety Strap	

\$1954.00

\$2247¹⁰ inc GST

Optional Accessories & Consumables



Holemaker Cutters



Twist Drill Chuck

PRO50 MAGNETIC BASE DRILL HMPRO50



Capacity (Diameter)	52mm
Capacity (Depth)	75mm
Capacity (Twist Drill)	#2 Morse Taper 23mm
Motor Power	1260 watt
Input Power	1340 Watt Single Phase 240V
Speed	2 speed 200 / 400rpm
Weight	16.5kg
Magnetic Dead Lift	12000Nm On 25mm Steel Plate
Stroke	153mm
Height (min / max)	426mm / 579mm
Through Spindle Coolant System	
Smart Magnet Technology To Ensure Sufficient Magnetic Adhesion	
Supplied In Metal Carry Case With Cutter Guard & Safety Strap	

\$2893.00

\$3326⁹⁵ inc GST

Optional Accessories & Consumables



Holemaker Cutters



Taper Shank Drills



Twist Drill Chuck

Mag Drill Accessories **Holemaker**

QUALITY EUROPEAN MADE MAGNETIC DRILLING MACHINES

SILVER SERIES ANNULAR CUTTER SETS



ASSET-A



ASSET-B

FROM

\$184.00

\$211.60 inc GST

- M2AL High Speed Steel Material
- Hole Diameter: 12mm
- Depth of Cut (DOC): 25mm
- Pilot Pin Diameter: 6.35mm
- Shank Diameter: 3/4" (19.05mm)

ASSET-A - 6 Piece \$184.00 (ex gst)
 Kit Includes:
 14 x 25mm 16 x 25mm
 18 x 25mm 20 x 25mm
 22 x 25mm
 Pilot Pin To Suit

\$211.60 (inc gst)

ASSET-B - 12 Piece \$332.00 (ex gst)
 Kit Includes:
 12 x 25mm 13 x 25mm
 14 x 25mm 16 x 25mm
 17 x 25mm 18 x 25mm
 20 x 25mm 22 x 25mm
 24 x 25mm 26 x 25mm
 Pilot Pin To Suit

\$381.80 (inc gst)

CUTTING FLUIDS



TAP MAGIC CUTTING FLUID

- TAP MAGIC EP-XTRA is highly effective for all cutting operations on all Metals.
- You will especially appreciate the performance of this cutting fluid on hard metals and with difficult extreme-pressure cuts of long duration.
- You will also note dramatic improvements in tool life.

FROM

\$12.00

\$13.80 inc GST

HOLEMAKER METAL WORKING FLUID

Extra heavy duty, water soluble metal working fluid for use with Holemaker annular cutters and other arduous machining applications on ferrous and non ferrous metals.

- Formulated to extend tool life and improve surface finish
- Contains corrosion inhibitors to protect machine parts
- High resistance to bacterial and fungal growth

Mix 1 part fluid to 10 parts water

Part No.	Description	Price	
		ex GST	inc GST
SPFLUID	500ml Metal Working Fluid	\$15.00	\$17.25
SPFLUID1	1 Litre Metal Working Fluid	\$26.00	\$29.90
SPFLUID5	5 Litre Metal Working Fluid	\$115.00	\$132.25
SPFLUID20	20 Litre Drum With Provision to Fit Tap	\$308.00	\$354.20
TAP10125E	125ml EP-Extra Cutting Fluid	\$12.00	\$13.80
TAP10500E	500ml EP-Extra Cutting Fluid	\$27.00	\$31.05
TAP11000E	1 Litre EP-Extra Cutting Fluid	\$47.00	\$54.05

MOULDED EVA FOAM KNEE PADS

TG281602



\$14.00

\$16.10 inc GST

- Made from durable moulded dense foam material
- Light-weight for all-day wear
- Adjustable elastic straps with hook and loop fasteners
- Perfect for DIY as well as the Professional
- One size fits most

Foam - 100% Ethylene Vinyl Acetate (EVA)
Lining - 100% Polyester
Elastic - 65% Polyester / 35% Elastane

**** Sold per Pair ****

PROFESSIONAL MOULDED KNEE PADS

TG281630

\$30.00

\$34.50 inc GST



- EVA Foam padding with a soft Gel Core.
- Durable thick PVC shell.
- Stretch fit neoprene straps with adjustable upper clips.
- Industrial strength Velcro.
- One size fits most.

Perfect for construction, flooring, and carpet installations, working on concrete and hardwood floors, welding, stocking shelves, gardening, cleaning and more.

ECONOMY BACK SUPPORT BELTS



FROM

\$20.00

\$23.00 inc GST

Industrial Style Back Support provides comfortable relief from lower back discomfort.

TG02613M - Medium (100cm)	\$20.00 <small>(ex gst)</small>	\$23.00 <small>(inc gst)</small>
TG02613L - Large (108cm)	\$21.00 <small>(ex gst)</small>	\$24.15 <small>(inc gst)</small>
TG02613XL - XL (116cm)	\$22.00 <small>(ex gst)</small>	\$25.30 <small>(inc gst)</small>
TG02613XXL - 2XL (124cm)	\$23.00 <small>(ex gst)</small>	\$26.45 <small>(inc gst)</small>
TG02613XXXL - 3XL (132cm)	\$24.00 <small>(ex gst)</small>	\$27.60 <small>(inc gst)</small>

9 POCKET ELECTRICIANS TOOL POUCH

TG141503

\$32.00

\$36.80 inc GST



- Manufactured from polyester fabric.
- Attaches to belt with heavy duty clip or belt loop.
- Side pockets for use with screwdrivers and torches.
- Tape Sling for electrical insulating tapes.
- Webbing with reflective stripe.

ELECTRICIANS TOOL POUCH WITH BELT

TG5505



\$47.00

\$54.05 inc GST

- 3 large main pockets and 3 smaller pockets.
- 6 large screwdriver holders and 4 internal tool loops.
- Electrical tape chain and tool snap.
- Metal clip holds all measuring tape sizes.
- Double layer of rugged, ballistic poly fabric.
- Overall Size - 310 x 225 x 110mm

21 POCKET ELECTRICIANS TOOL POUCH

TG1509

\$85.00

~~\$97.75~~ inc GST



- 21 pockets to organise your tools and tester.
- Zipped cover to keep tools secure when not in use.
- Zipped back pocket for 200 x 125mm pad.
- Ergonomic rubber handle and padded shoulder strap design for easy storage and the ideal way to carry loaded tool pouch.
- Outside pocket to hold cell phone and 3 outside large screwdriver holders.
- Made of 600 x 600D polyester fabric and ballistic binding.
- Overall Size - 360 x 300 x 120mm

WIDE PADDED COMFORT BELT

TG5623

\$35.00

~~\$40.25~~ inc GST

- Heavy-duty, double layer fabric will not rot, crack, harden or mildew.
- Foam padding.
- Fits waist sizes - 66-116cm
- Width - 75mm (3")



TOOL LANYARD STANDARD

TG5600

\$9.00

~~\$10.35~~ inc GST

- Shock absorbing properties reduce the dynamic force on the body or other anchor point if drop occurs
- Durable polyester elastic blended webbing extends from 94 - 177cm
- Low profile lightweight design reduces snag hazards and added weight
- Alloy carabiner with captive eye
- Treaded loop end that grips the tool when attached
- Safe Working Capacity - 4.5kg
- Retracted Length - 94-177cm
- Extended Length - 177cm
- Width - 15mm



16" OPEN TOP CENTRE TRAY TOOL BAG

TG1529

\$80.00

~~\$92.00~~ inc GST

- Multi-compartment plastic parts tray included 178 x 105 x 31mm
- 9 Pockets outside and 8 inside to organise a wide range of tools and accessories.
- Main pocket with web loops to accommodate large tools.
- Extra padded carrying handles and adjustable shoulder strap.
- Metal tape clip and electrical tape strap.
- Made of 600 x 600D polyester fabric and ballistic binding.
- Overall Size - 400 x 250 x 220mm



16" OPEN TOP TOOL BAG

TG4516

\$92.00

~~\$105.80~~ inc GST

- 27 pockets inside 6 web sleeves provide storage and organisation for your favourite hand tools.
- Padded adjustable shoulder strap.
- Wide open main compartment.
- Sturdy metal handle bar with moulded foam grip for easy carrying.
- Moulded Water Resistant Rubber Base
- Overall Size - 410 x 210 x 330mm



24" OPEN TOP TOOL BAG

TG4524

\$106.00

~~\$121.90~~ inc GST

- 15 outer and 15 inner pockets.
- Padded adjustable shoulder strap.
- Wide open main compartment.
- Sturdy metal handle bar with moulded foam grip for easy carrying.
- Moulded Water Resistant Rubber Base
- Overall Size - 610 x 220 x 350mm



Hydration

SQWINCHER 2L CONCENTRATES



EACH

\$31.00

\$35.65 inc GST

- One 2L bottle makes up 20L
- One of the most affordable electrolyte replacement drinks in the country.
- Add one 2 litre Sqwincher concentrate bottle to a 20 litre Cooler (SQ01 or similar) and fill with water & ice to make up a Hydration Station that will keep fluid cold for up to 12 hours.

SQ0028 - Lemon / Lime
SQ0046 - Wildberry
SQ0050 - Grape

SQ0042 - Orange
SQ0047 - Tropical
SQ0052 - Lemonade

SQWINCHER 3GM SUGAR FREE QWIK STIKS 50 PACK



EACH

\$55.00

\$63.25 inc GST

- Single-serve pouch - simply pour directly into 600-750ml bottled water
- Sugar free for diabetics or carb conscious consumers
- Low in sodium, tastes great, provides fast hydration & helps prevent muscle cramps

Sqwincher is an electrolyte replacement drink scientifically formulated to safely replace mineral salts, replenish fluids and sugars at optimal absorption rates, which are depleted as a result of dehydration or through physical exertion. It prevents or reduces the severity of heat stress disorders and provides a supplemental source of energy.

SQ0100 - Orange
SQ0103 - Lemonade
SQ0106 - Grape
SQ0109 - Cool Citrus

SQ0101 - Mixed Berry
SQ0104 - Mixed Flavours
SQ0107 - Lemon / Lime

R-LINE 1L CONCENTRATES



EACH

\$13.00

\$14.95 inc GST



RL01 - Lemon / Lime
RL03 - Blueberry
RL02 - Orange
RL04 - Raspberry

R-Line™ Activity Drink is an isotonic electrolyte drink that has been specifically formulated for lower intensity activities like work and recreation. Scientifically formulated at a leading NZ university for Kiwi conditions, R-Line™ is made in NZ for New Zealanders! Over 35% less sugars, and more total electrolytes than other leading brands.

Makes 10 Litres | 40 Servings (250ml)
Electrolyte Level: 30mmol / Litre
Carbohydrate Level: 5g / per 100ml
Energy: 82.5kJ / per 100ml

SQWINCHER 20L COOLER SQ01



\$141.00

\$162.15 inc GST

- Sqwincher industrial strength coolers are made to last
- Keeps fluid cold for hours
- High visibility yellow
- All plastic rust proof construction with UV inhibitors to prevent fading
- Mix one 2 litre bottle of Sqwincher concentrate into the 20L Cooler, then add water and ice to make up a hydration station that will keep fluid cold for up to 12 hours
- Cup dispenser bracket fitted to all coolers

The MEGA MASTER

A tool kit classic!



Part # TCMM1001N

\$5800.00

\$6670.00 inc GST

Top Box



Roll Cab



Middle Box



1001 piece tool kit reigns supreme. If you are looking for a complete tool kit where every tool has it's own place, then look no further.

- 1/4", 3/8", 1/2" & 3/4" Dr • Std, deep, flex, hex, TX, TPX, TX-E impact sockets • 4 Ratchets
- 35 Screwdrivers • 74 Pc Ratchet Screwdriver Set • 24 Pliers • 2 Torque Wrenches
- 69 Spanners • Nut Drivers • Rivet & riv-nut Sets • Pry Bars & Roll Heel Bars • Puller Kit
- Tap & Die Set • Stud Removers • Punch & Chisel Set • 1000V Pliers & Screwdrivers
- Crimping Tool Set • Oil Service Kit • General Tool Kit & So Much More



SCREWDRIVERS



SCREWDRIVER SET

10 Pieces
1000V

- TT-MV PLUS steel blades for added torque
- Ergonomically designed bi-material handles

\$60.00

~~\$69.00~~ inc. GST

Part # MD910N



SCREWDRIVER SET

53 Pieces



- TT-MV PLUS steel blades for added torque
- Ergonomically designed bi-material handles

\$186.00

~~\$213.90~~ inc. GST

Part # MD9053N

SCREWDRIVER SET



\$67.00

~~\$77.05~~ inc. GST

- 7 Pieces
- TT-MV PLUS steel blades for added torque
 - Ergonomically designed bi-material handles

Part # TT917N

TX SCREWDRIVER SET



\$67.00

~~\$77.05~~ inc. GST

- 7 Pieces
- TT-MV PLUS steel blades for added torque
 - Ergonomically designed bi-material handles

Part # TT917TXN



SCREWDRIVER SET



\$100.00

~~\$115.00~~ inc. GST

- 8 Pieces
- TT-MV PLUS steel blades for added torque
 - Ergonomically designed bi-material handles

Part # TTX918N



MINI BITS RATCHET

Part # 1400B

\$42.00

~~\$48.30~~ inc GST



STUBBY BITS DRIVER

Part # MD908N

\$21.00

~~\$24.15~~ inc GST



STUBBY RATCHETING BITS DRIVER

Part # MDR908S

\$19.00

~~\$21.85~~ inc GST



RATCHETING BITS DRIVER

Part # MDR908

\$24.00

~~\$27.60~~ inc GST



14 in 1 RATCHETING BITS DRIVER

Part # MDR915

\$30.00

~~\$34.50~~ inc GST



FLEXIBLE RATCHET BITS DRIVER

Part # MDRT908

\$63.00

~~\$72.45~~ inc GST



QUICK CHUCK BITS DRIVER | 217mm

Part # MDQ217

\$22.00

~~\$25.30~~ inc GST



QUICK CHUCK BITS DRIVER | 183mm

Part # MDQ183

\$21.00

~~\$24.15~~ inc GST



QUICK CHUCK BITS DRIVER | 147mm

Part # MDQ147

\$18.00

~~\$20.70~~ inc GST



RATCHETING QUICK CHUCK DRIVER

Part # MDRQ908

\$37.00

~~\$42.55~~ inc GST



T HANDLE QUICK CHUCK DRIVER

Part # MDTHQ

\$25.00

~~\$28.75~~ inc GST



MAGNETIC BITS HOLDER | 217mm

Part # MD216

\$15.00

~~\$17.25~~ inc GST



MAGNETIC BITS HOLDER | 193mm

Part # MD193

\$15.00

~~\$17.25~~ inc GST



FLEXIBLE BITS DRIVER

Part # MD907FL

\$24.00

~~\$27.60~~ inc GST



HOSE CLIP DRIVER | 6/7mm

Part # MD503N

\$16.00

~~\$18.40~~ inc GST



HOSE CLIP DRIVER | 7mm

Part # MD503NA

\$13.00

~~\$14.95~~ inc GST



HOSE CLIP DRIVER | 8mm

Part # MD503ND

\$13.00

~~\$14.95~~ inc GST



FLEXIBLE EXTENSION | 300mm

Part # ACC300CBH01

\$23.00

~~\$26.45~~ inc GST



EXTENSION | 100mm

Part # TTMD74-1

\$2.00

~~\$2.30~~ inc GST



EXTENSION | 150mm

Part # TTMD74-2

\$5.00

~~\$5.75~~ inc GST

Get organised



MAGNETIC GRASSHOPPERS

- Spring-loaded arm self-adjusts for REPETITIOUS WORK HOLDING.
- Adjustable V-Pad Base adapts to: round, square, flat, and angled surfaces.
- Anti-tipping Bolt provides stability.

STRONG HAND TOOLS®
PATENT PENDING
All Rights Reserved.

**Use the "third hand"
to steady parts for
tack welding!**

Safe and convenient!

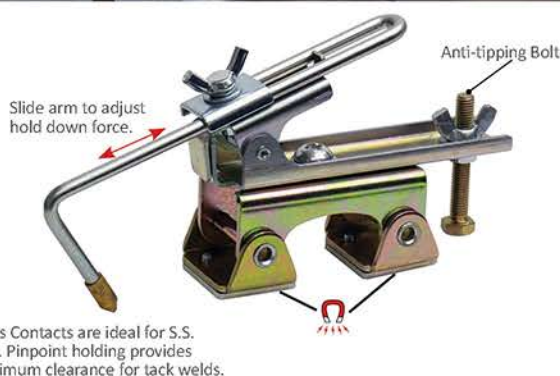

Magnetic Model - SHAGH200 / SHAGH230

FROM
\$36.00
\$41.40 inc GST

NEW

Part No.	Feature	Magnetic V-Pad Base	Anti-tipping Bolt	Max. OAL (mm)	Width x Height (mm)	Weight (kg)	Price	
							ex GST	inc GST
SHAGH200	Brass Contact	✓	✓	203	64 x 76	0.3	\$36.00	\$41.40
SHAGH230	Brass Contact	✓	✓	234	100 x 100	0.6	\$48.00	\$55.20

⚠ Must be used for tack welding only and removed before completing weld. Avoid prolonged exposure of magnetic products to heat sources of 176°F / 80°C.

STANDARD GRASSHOPPERS



Pro Model - SHAGH130P



Econo Model - SHAGH130

FROM
\$36.00
\$41.40 inc GST

Part No.	Product Includes	Max. OAL (mm)	Width x Height (mm)	Weight (kg)	Price	
					ex GST	inc GST
SHAGH130P	Three Brass Contacts, Copper Ribbon, Spring Clip Attachment	300	114 x 102	0.7	\$45.00	\$51.75
SHAGH130	Brass Contact	300	114 x 102	0.7	\$36.00	\$41.40





FROM

\$24.00

\$27.60 inc GST

Hold stock from the outside when inside access is difficult.

Hold and position sheet metal, round pipes, square, angled or flat stock.

The Inside / Outside Angle Magnets are constructed from two independent rectangular magnets for consistent, undiminished magnetic force when both sides are attached to workpieces.

Use mounting holes to link two magnets together for use as fixturing elements.

Use hex hole on magnet for breakaway leverage.



Part No.	Angles	Height (mm)	Width (mm)	Thickness (mm)	Mag. Pull Force (kg)	Weight (kg)	Price	
							ex GST	inc GST
SHMLDT350 COMBO PACK: (MLD300) + (MLD500)						0.5	\$30 ⁰⁰	\$34 ⁵⁰
1pc. (SHMLD300)	90°, 30°/60°	76	52	14	9			
1pc. (SHMLD500)	90°, 30°/60°	125	85	18	15			
SHMLD600	90°, 30°/60°	165	110	20	18	0.8	\$24 ⁰⁰	\$27 ⁶⁰
SHMLA450	30 ~ 270°	120	120	18	12	0.5	\$30 ⁰⁰	\$34 ⁵⁰
SHMLA600	30 ~ 270°	156	156	20	15	0.9	\$39 ⁰⁰	\$44 ⁸⁵

NEW

* Magnetic force is based on 10mm thick steel.

⚠ **Must be used for tack welding only and removed before completing weld. Avoid prolonged exposure of magnetic products to heat sources of 176°F / 80°C.**

POWERBASE™ GROUNDING MAGNETS

FROM
\$122.00
\$140.30 inc GST

Power through your grounding applications! Start grounding instantly!

- The PowerBase™ Grounding Magnet sets up quickly and easily.
- Powerful rare earth magnet delivers heavy duty holding power.
- The "V" machined surface grips round parts.
- The copper connector stud allows for better conductivity.



Large copper connector for better conductivity.



Holds securely onto round or flat surfaces.



The ON/OFF Lever is easy to turn, even while wearing gloves.



Turn OFF the PowerBase™ Grounding Magnet and metal chips fall away.

Part No.	Amperage	Dimension (mm)	Magnetic Force (kg)	Weight (kg)	Price	
					ex GST	inc GST
SHGM203	300A @ 60% Duty Cycle	50 x 50 x 64	20	0.5	\$122.00	\$140.30
SHGM205	500A @ 60% Duty Cycle	50 x 70 x 64	50	1.1	\$165.00	\$189.75

⚠ Must be used for tack welding only and removed before completing weld. Avoid prolonged exposure of magnetic products to heat sources of 176°F / 80°C.

GROUNDING CLAMP

Clamping + Grounding at the same time.

Consistently rated at 300 AMPS

Solid, insulated copper U-Channel rotates for easy access and can attach to round / odd-shaped parts.

SHGB428M

\$43.00
\$49.45 inc GST

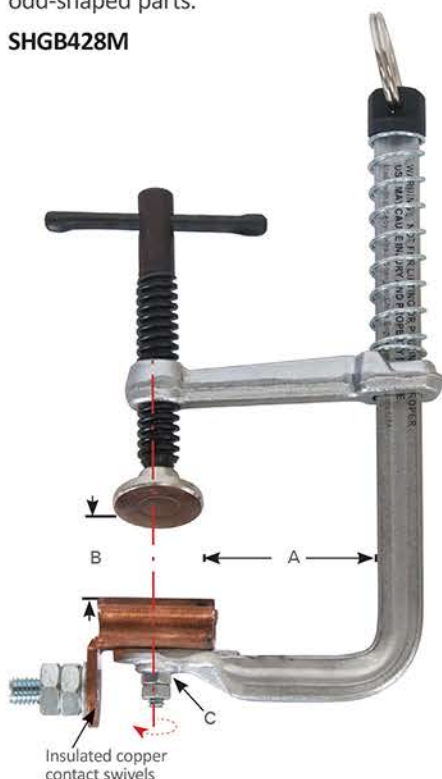

NEW



Part No.	Amperage / Cable Size	Throat Depth (A) (mm)	Max. Capacity (B) (mm)	Tapped Hole (C)	Clamping Pressure (kg)	OAL (mm)	Weight (kg)
SHGB428M	300A / --	64	75	M6	100	180	0.4

Locking C-Clamps

**Strong
Hand
Tools**

Improved features for professionals and Do-It-Yourselfers.

Made of heat treated steel and nickel/chrome plated for strength and durability. Updated features help you work quickly, safely and efficiently.

FROM

\$22.00

\$25.30^{inc GST}

Round Tip Model

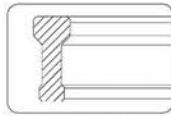

Cross Section

Made of heat treated steel and nickel/chrome plated for strength and durability.



Secure Adjustment Bar

Minimises adjustment bar pop outs.

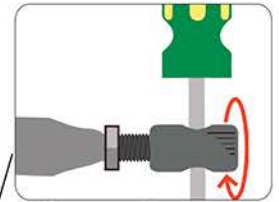

Adjustment Screw

Large adjustment screw with a hole for easy torque.



Optional Crank Handle

See page 48 for details.

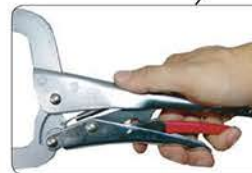

Single Hand Release Handle

Vinyl coated release handles made for comfort and ease.

SHPR115

Swivel Pad Models



SHPR115S



SHPR18S



NEW

	Part No.	OAL (mm)	Throat Depth (mm)	Opening (mm)	Weight (kg)	Price	
						ex GST	inc GST
Round Tip	SHPR6	165	46	56	0.2	\$22.00	\$25.30
	SHPR115	280	83	100	0.9	\$31.00	\$35.65
	SHPR18	450	254	114	1.4	\$58.00	\$66.70
Swivel Pad	SHPR6S	165	46	56	0.3	\$25.00	\$28.75
	SHPR115S	280	83	100	1.0	\$35.00	\$40.25
	SHPR18S	450	254	114	1.4	\$62.00	\$71.30

PIPE ALIGNMENT CLAMPS WITH QUICK-ACTING LEVER

The New Pipe Alignment Clamp with Quick-Acting Lever is a fast, accurate fit-up clamp with a rugged frame.

Get a well-balanced hold on the clamp with the two wide Grip Plates while pressing the Quick-Acting Lever. The screw smoothly glides up and down for fast jaw insertion and clamp removal after welding.

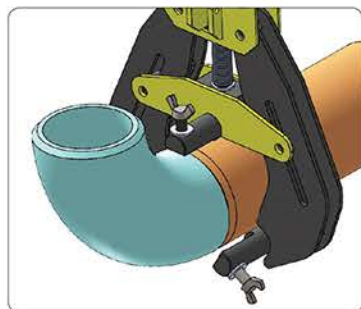

Pipe to Elbow

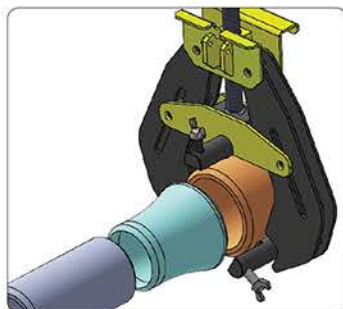

Pipe to Reducer

Part No.	Pipe Diameter Capacity (mm)	Weight (kg)	Price	
			ex GST	inc GST
SHCPA60	50 ~ 152	5.0	\$284. ⁰⁰	\$326. ⁶⁰
SHCPA120	144 ~ 305	7.8	\$528. ⁰⁰	\$607. ²⁰



Quick-Acting Lever

All Stainless Steel Contacts

FROM
\$284.⁰⁰
\$326.⁶⁰ inc GST

NEW

PRESS - SLIDE - SET

Wide Grip Plates make this Pipe Alignment Clamp easier to handle, with less user fatigue.



PIPE FIT-UP CLAMPS

A compact, light weight, portable clamp for the quick fit-up of round pipes and flanges for butt welding. Easy-to-Use design for the rapid, repeated loading and unloading of workpieces.

Pre-set clamp opening for fast setup:

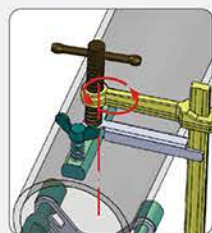

1. Loosen all three SS screws slightly. Clamp the three SS Clamp Rods to hold the pipe. [Slightly] tighten all three screws, then loosen 1/4 turn. Loosen clamp by turning the spindle.

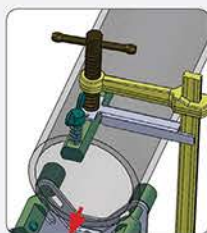

2. Move the clamp forward to accept the 2nd pipe or flange. Clamp all three SS Clamp Rods to hold the 2nd pipe.

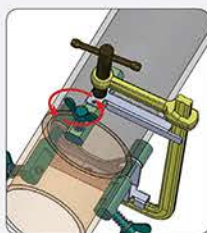

3. Adjust the 2nd pipe or flange position using the three SS screws. After properly aligning the pipes, tighten the three SS screws.

Part No.	Pipe Diameter Capacity (mm)	OAL (mm)	Weight (kg)	Price	
				ex GST	inc GST
SHCPL45	50 ~ 100	240	1.3	\$133. ⁰⁰	\$152. ⁹⁵
SHCPL75	100 ~ 140	304	2.1	\$169. ⁰⁰	\$194. ³⁵

NEW

All Stainless Steel Contacts
88mm L Clamp Rods



Fine Adjustment Screws

FROM
\$133.⁰⁰
\$152.⁹⁵ inc GST

ADJUSTABLE REACH & LONG REACH MULTI-PURPOSE PLIERS

Thread - M10 | Opening - 100mm

SHPGA20M - Adjustable Reach Arms

Top Adjustable Spindle - No-mar rubber pads, pivoting head.
Bottom Adjustable Spindle - No-mar rubber pads, fixed head.



SHPGA20S - Adjustable Reach Arms, with top and bottom fixed jaws, pivoting heads, and no-mar rubber pads.



EACH

\$71.00

\$81.65 inc. GST

Part No.	OAL (mm)	Throat Depth (mm)	Weight (kg)
SHPGA20M	585 - 740	350, 405, 460 & 510	2.2
SHPGA20S	585 - 740	350, 405, 460 & 510	2.2

ECONOMY PIPE PLIERS

Large Capacity (75mm)! Holds round, square, flat or angled. The large (Ø 38mm) swivel pad makes alignment easier!

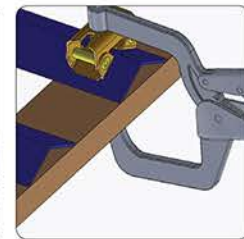
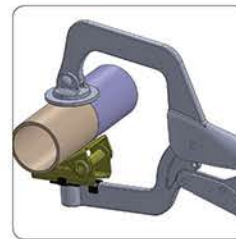

\$33.00

\$37.95 inc. GST

Part No.	Opening Round / Square (mm)	OAL (mm)	Weight (kg)
SHPVS100	up to 75	360	1.0

LOCKING CHAIN PLIERS

Clamp odd shaped multiple items. **Adjust tension with crank handle.**

Replaceable chain available in 600mm (SHPXC24), 910mm (SHPXC36) & 1200mm (SHPXC48) lengths.



FROM

\$48.00

\$55.20 inc. GST

Part No.	Chain Length (mm)	Holds Pipes (mm)	Weight (kg)	Price	
				ex GST	inc GST
SHPFC1024	600	up to 165	0.9	\$48.00	\$55.20
SHPFC1036	910	up to 270	1.1	\$54.00	\$62.10
SHPFC1048	1,200	up to 360	1.4	\$59.00	\$67.85

LICENSED TO CHILL

COOLER / CHILLY BINS

- High-Density Polyethylene
- Fitted with 2 x Bottle Openers
- Fully Moulded & Integrated Hinge System
- Heavy Duty Carry Handles & Drain Valve
- Food Grade Liner

Optional Accessories (Not Included)

Cup Holder

Basket for inserting into Chilly Bin



PM9450 - 25 Litre

\$207.83 (ex GST)

PM9452 - 33 Litre

\$233.91 (ex GST)

PM9454 - 47 Litre

\$303.48 (ex GST)

PM9458 - 71 Litre w/wheels

\$407.83 (ex GST)

FROM

\$207.83

\$239.00 inc GST

\$239.00 (inc GST)

\$269.00 (inc GST)

\$349.00 (inc GST)

\$469.00 (inc GST)

SLEEVE TYPE DRY BAG GEAR PROTECTORS

- 250D Water Resistant Tough PVC material
- Roll top design with RF welded seams
- Easy breakaway buckle enclosure with shoulder strap
- Waterproof and Lightweight

PM9410S - 10L **\$16.43** (ex GST) **\$18.90** (inc GST)

PM9420S - 20L **\$19.04** (ex GST) **\$21.90** (inc GST)

FROM
\$16.43
\$18.90 inc GST

18L BACK PACK DRY BAG GEAR PROTECTOR

PM9418B

\$51.30

\$59.00 inc GST

- 250D Water Resistant Tough PVC Material
- IPX6 Waterproof Protection
- Handgrip & Two Shoulder Straps
- Overlapped Main Lid with Weather Resistant Zippers
- 7 Pockets & 3 Zippers



40L BACK PACK DRY BAG GEAR PROTECTOR

PM9430B

- 500D water resistant tough PVC material
- Solid roll-top closure system provides secure watertight seal
- Easy breakaway buckle enclosure with handgrip & two shoulder straps
- The dry sack can float on water after rolled and buckled, so you can track your gear easily

\$68.70

\$79.00 inc GST



Outdoor Accessories

FLOATING PHONE POUCH

- Material - PVC
- Waterproof - IPX8
- Includes Lanyard
- Compatible with Phone Sizes Smaller than L 165mm, W 80mm

PM623008 - Black

PM623010 - Light Blue



FROM

\$10.43

\$12.00 inc GST

CAR ROOF PADS - SELF INFLATING

PM9310

Multi-purpose, universal roof bar system that can be fitted and removed in just minutes. Rack will simply inflate by itself when you open the valves.

\$112.17

\$129.00 inc GST

- Portable Roof Rack for Kayaks, SUP, Luggage etc.
- Self-Inflating Air Pads
- Storage Bag & Roof Rack Pad Tie Down Straps included.
- Pad Length - 0.85m (100mm wide)
- Strap Length - 1.1m (40mm wide)
- Maximum Load Capacity - 80kg



SOFT KAYAK ROOF RACK

PM9315

Car Roof Rack Pads for securing Surfboards, Snowboards, most Kayaks & Stand-Up Paddle Boards.

\$86.09

\$99.00 inc GST

- 2 x Large Aero Bars consist of EVA Foam within a Weatherproof 600D Polyester Sleeve.
- 2 x Waterproof Straps.
- Straps wrap around the inside of your vehicle.
- Soft Padding & Sturdy Buckles ensure boards will not slip or move around.
- Pad Length: 0.7m (483mm wide)
- Strap Length: 3.7m (38mm wide)



STEEL KAYAK / SUP CEILING STORAGE RACK

PM9325

Go overhead when your're short on storage space!

Sold as a Pair

\$129.57

\$149.00 inc GST

- Suitable for Kayak / SUP / Surfboard
- Mount to ceiling, under a deck or covered patio
- Adjustable height fits Kayaks & Boards
- Storage configuration side-by-side or stacked
- Foam padded arms
- Expandable to store up to 4 watercraft
- Maximum capacity - 90kg

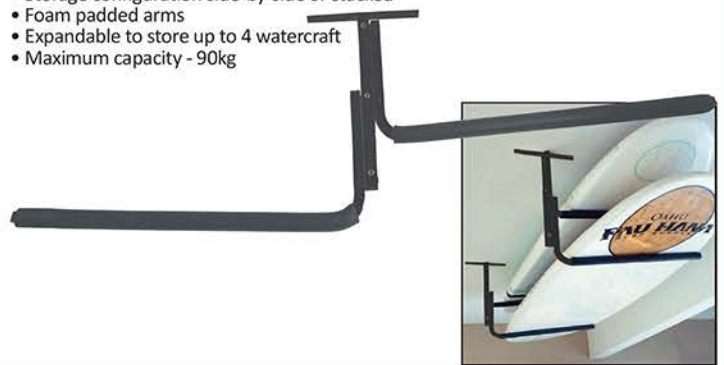

ALUMINIUM SIT ON TOP KAYAK CART

PM9320

Alloy Kayak Cart for kayaks and canoes is a great way to get your boat and gear to and from the water.

\$94.78

\$109.00 inc GST

- Universal Lightweight Kayak Carrier
- Suitable for all open kayaks, platform boats, drift boats
- Load Capacity - 75kg
- Foam Bumpers
- Tough Alloy Tubing Resists Corrosion
- Welded Construction Ensures Durability



SNAPPER CATCHER LUMO FOUR PACK (5/0)

PM613180

4 Pc Pack Includes;

Purple & Lumo

Pink & Lumo

20% Lumo Material on each Rig

Hook Size - 5/0

• Trace Capacity 40lb

Red & Lumo

Blue & Lumo

\$42.61

\$49.00 inc GST



Clearance

3L HI VIS ORANGE HYDRATION BACKPACKS

Handy 16" x 8" front pocket with 10" opening.
Features velcro connections between the shoulder straps and bag, will separate if part of the bag gets caught in machinery.

D1050 - Orange

D1051 - Lime Green



EACH

\$159.00

\$182.85 inc GST

100 PC SAFETEC LENS TISSUE WIPE SACHETS SA350

- 100 individually wrapped lint free towelettes
- Wipes help workers meet OSHA safety equipment care guidelines
- The streak-free formula dries instantly
- The anti-static formula helps reduce the build up of lint and dust
- The anti-fog formula repels moisture to help provide clearer vision
- Large 5" x 8" towelette.

For use on glass & plastic surfaces: All types of eyewear, Safety glasses, Computer screens, Keyboards, Phones, Copier glass and more.
*NOT FOR USE ON CONTACT LENSES.



\$18.00

\$20.70 inc GST

RATCHET LOAD BINDERS



• 100% Polyester webbing
Caution: Must not be used for lifting.

LOADB38MD - 6m x 35mm
• 1000kg (10Kn) End Lash Capacity

LOADB50HD - 9m x 50mm
• 2500kg (25Kn) End Lash Capacity

• Manufactured to AS/NZS 4380/2001

\$14.00 (ex GST)

\$16.10 (inc GST)

• 35mm Ratchet Buckle Load Binder

\$22.00 (ex GST)

\$25.30 (inc GST)

• 50mm Ratchet Buckle Load Binder

720 TRADES WITH TOUCH CONTROL GLOVES

- Visco-elastic gel polymer palm pad to dampen shock and impact
- Abrasion resistant, textured PVC on palm and fingers
- Breathable, 3-layer stretch spandex with neoprene knuckle pad
- Synthetic leather palm and fingers
- Terry thumb brow wipe
- 1/2-finger on thumb, index, and middle fingers

ER72016182 - Small

ER72016183 - Medium

ER72016184 - Large

ER72016185 - X Large

ER72016186 - 2 X Large



EACH

\$36.00

\$41.40 inc GST

872 HI VIS GENERAL DUTY MESH GLOVES

- Breathable, polyester hi-vis Air-Mesh back
- 3M™ reflective tape zones on back
- Durable synthetic leather palm
- Abrasion resistant, textured PVC on palm and fingers
- Breathable neoprene cuff with low-profile closure
- Terry thumb brow wipe

ER87216313 - Medium

ER87216314 - Large

ER87216316 - 2 X Large



EACH

\$36.00

\$41.40 inc GST

16 POCKET TOOL POUCH WITH LOOP ATTACH ER551813642

Topped Tool Pouch - Loop Attachment: Easily attaches to any belt while keeping tools and fasteners secure.

- 1680D ballistic Polyester
- 16-pockets for tools and fasteners
- Top cover flap with hook and loop closure
- Four nickel-plated D-rings for tool lanyard attachment
- Patented Storm Drains
- Abrasion-resistant reinforced pouch bases
- Maximum safe working capacity - 15kg (33lb)
- Third-party certified to a 4:1 safety factor
- Capacity - 8.9L (544.5in³)

Tools and Accessories Shown are NOT included



\$51.00

\$58.65 inc GST

8 POCKET NAIL & TOOL POUCH KUAP1823

A superior quality, heavy-duty nail and tool bag with 2 main pockets and 6 smaller pockets and sleeves to hold your nails, fasteners and tools, includes 2 metal hammer loops.

- Fits belts to 5cm wide.
- 2 main nail and tool pockets.
- 6 smaller pockets for pencils, nail sets, etc.
- Steel hammer holders.
- Made of polyester fabric and ballistic binding.
- May be worn on left or right side.

Tools and Accessories Shown are NOT Included



\$12.00

\$13.80 inc GST

22 POCKET DRAWSTRING BUCKET BAG KUBB10

- 6 Large inside compartments for organising and stowing small parts.
- 16 Pockets inside and 6 pockets outside.
- Unique easy-lock/push-button-release drawstring system.
- Reinforced web loop carrying handle.
- "Soft" bottom panel prevents tipping and spilling.
- Heavy Duty stitching & bar tacking at stress points.
- Fits into any standard 11L to 18L bucket.
- Stack 3 or 4 drawstring bags inside one bucket.
- Built of super tough, super light polyester fabric for durability and long wear.

Tools and Accessories Shown are NOT Included



\$11.00

\$12.65 inc GST

BUCKET BAGS

IN AND OUT BUCKET POCKETS

- Designed to fit most standard 11L to 18L buckets.

Tools and Accessories Shown are NOT Included

- KUBB32 - 30 Pockets** **\$22.00** (ex gst) **\$25.30** (inc gst)
- 16 pockets inside and 14 pockets outside.
 - Multi-sized tool pockets located both inside and out for easy access, better organisation.
 - Rugged yet lightweight soft-sided tool organiser perfect for any use in the field or at home.

- KUBB43 - 48 Pockets** **\$26.00** (ex gst) **\$29.90** (inc gst)
- 14 double row inside pockets and 34 triple row pockets outside.
 - Multi-sized tool pockets store a wide range of tools and accessories.
 - Drill pocket with hook and loop handle strap.



30 POCKET ALL IN ONE BUCKET BAG

KUSW1118

KUNYS Bucket Bag is manufactured from rugged polyester fabric and is designed to fit most 10 & 20 litre pails, these versatile bucket bags come with the following features:

- 30 double row multi-size outside pockets to organise a wide range of tools and accessories.
- Drill pocket with hook & loop handle strap.
- Tape strap and Key clip included.
- Security pocket with hook & loop closure
- Designed to fit most 10 & 20 litre buckets.

Tools and Accessories Shown are NOT Included



24 POCKET 18" SOFT SIDED CARPENTERS BAG

KUSW1532

- 16 Multi-use outside pockets and 8 inside pockets to organise tools and accessories.
- Padded rubber web carrying handle and adjustable shoulder strap.
- Large interior to carry a wide variety of carpenter's tools.
- 2 Large side pockets with loops to hold large handle tools.
- Mesh zippered pocket for easy view of pocket contents.
- Approx. Dimensions - L 460 x W 230 x H 305mm

Tools and Accessories Shown are NOT Included



23 POCKET 12" BIGMOUTH TOTE BAG

KUSW798

- 17 Multi-use pockets inside and 6 outside to organise tools and accessories.
- Opens wide for easy access to bag's contents.
- Padded web carrying handles.
- Heavy-duty stitching and bar tacking at all stress points.
- L 300 x W 215 x H 200mm

Tools and Accessories Shown are NOT Included



ELASTIC BACK SUPPORT BELTS

- 200mm Wide heavy duty elastic back panel.
- 125mm Wide heavy elastic bands for custom fit.
- 30mm Wide elastic adjustable suspenders.
- 4 Internal stays provide extra support.
- Tapered front panels for comfort while bending.

- KUEL892 - Large** **\$44.00** (ex gst) **\$50.60** (inc gst)
- Fits waist sizes 71-111cm
- KUEL888 - XL** **\$49.00** (ex gst) **\$56.35** (inc gst)
- Fits waist sizes 116-142cm



12 POCKET 600D APRON

KUAP1429

This deluxe quality carpenter's work apron has a 5cm wide web belt with an interlocking buckle, and it has 4 main pockets with 8 smaller pockets and sleeves, including a swinging hammer loop.

- 4 main nail and tool pockets.
- 8 smaller pockets, sleeves and holders for pliers, pencils, nail sets, etc.
- Center pocket for tape, nails or other tools.
- Pry bar or combination square holder.
- Made of polyester fabric and ballistic binding.
- 5cm wide web belt with steel buckle.
- Fits waist sizes: 73-116cm

Tools and Accessories Shown are NOT Included



3 X 3M POP UP HEAVY DUTY GAZEBO - BLUE
PE2633

Heavy Duty Gazebo is ideal for various outdoor events like markets, sports, camping or trade shows, is UV & water resistant and easy to set up (with two people).



\$361.00

\$415.15 inc GST

Features:

- Adjustable height legs (3.1m max to top of peak)
- Heavy duty powder coated steel frame
- Canopy x 1 - 250g polyester with PVC coating (SPF 50+)
- 420D waterproof oxford fabric 2.9m x 5.8m included (covers all three sides)
- Complete with storage carry bag (with wheels).

Frame Specifications:

- Main frame - 30 x 30mm, 0.6mm thick
- Roof beam - 25 x 12mm, 0.5mm thick
- Adjustable height - 198cm, 191cm, 184cm, 177cm

Note: The gazebo is not designed as a permanent structure and it is not recommended to be used under extreme weather conditions or for a prolonged period of time. 12 month limited manufacturers defect warranty on Frame only.



www.isl.nz

Stores advertised on this page of this catalogue are independent businesses. Every effort is made to ensure advertised stock is available, but due to factors beyond the control of ISL Industrial Limited (Importer), not all products in this catalogue are available at all stores. Prices for the products are recommended only. Regular prices may vary from store to store, the catalogue pricing is calculated in good faith as the average price at the time of preparation. ISL Industrial Limited (Importer) reserve the right to correct printing & pricing errors. **Additional freight charges may apply if product is ordered in.** All sizes shown are approximate only. Accessories shown do not come with product unless otherwise specified. Due to printing process, colours in this catalogue may vary slightly to actual item. ISL Industrial Limited (Importer) will do everything possible with in reason to maintain stocks of products advertised but cannot be responsible for unforeseen shortfalls beyond their control. Reproduction in whole or part is prohibited without written approval © 2019. E & OE.